

CHATTERBOX INSTRUCTIONS

1. Fold each corner to the opposite corner. Open paper up. You should have creases in your paper that look like this.

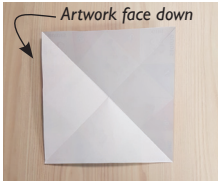

2. Fold each corner to the centre of the paper.

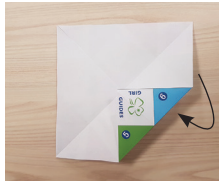

3. Now your paper should look like this.



4. Turn your paper over so the folds you just made are face-down.

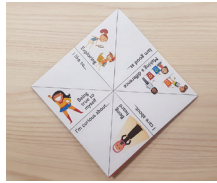

5. Just like in Step 2, fold each corner to the centre of the paper.



6. Your paper should look like this.

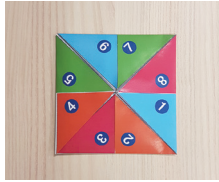

7. Now fold your paper in half, vertically and horizontally.

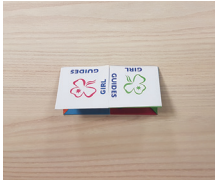

8. Insert your fingers underneath the tabs.



9. You're done!



GIRL GUIDES
AUSTRALIA
VICTORIA

Suite 812, 401 Docklands Drive
Docklands VIC 3008
Telephone +61 3 8606 3500
guides@guidesvic.org.au
www.guidesvic.org.au



A large sheet of paper for cutting out a cube-shaped chatterbox. The sheet is divided into eight triangular sections, each with a number in a blue circle and a specific theme. The sections are: 1 (blue, 'I'm good at...'), 2 (orange, 'Making a difference'), 3 (pink, 'I care about...'), 4 (orange, 'Being heard'), 5 (green, 'I'm curious about...'), 6 (blue, 'Being true to myself'), 7 (green, 'I like to...'), and 8 (pink, 'Exploring'). Each section also features a small illustration related to the theme. The sheet includes the Girl Guides Australia logo and the text 'GIRL GUIDES' and 'GIRL GUIDES' in various orientations. A dashed line indicates where to cut, and a pair of scissors icon is shown at the top right.